

- 002-02-011
Glide Ring, 04 Slim R_RL_RLC_X
- 222-01-099
Piston: Rebound, 36_40, Kidney, Radiused Step
- 045-00-035
Valve: Metric [13.0mm OD X 8.1mm ID X 0.15mm TH]
- 039-00-120
Spring: Rebound Check, 09 36_40
- 210-22-248
Insert, Rebound, 09 36_40, Check Limiter
- 029-08-029
O-Ring [7.0MM ID x 1.0MM CS]
- 029-08-004
O-Ring [3.0MM ID x 1.0MM CS]
- 039-00-131
Spring: [.690 TLG X .242 ID X 22.0 lb/in] Stainless Steel
- 210-22-244
Damp Adj Part: Needle, Rebound, High-Flow, 6 Flutes
- 210-10-040
Damping Adjust Part: Bolt, Rebound Piston, High-Flow, 32
- (045-00-074)
- 045-00-074
Valve: Metric [13.2mm OD x 6.4mm ID x 0.15mm TH]

204-74-011
Rebound Tube: Machined, 011 32 X

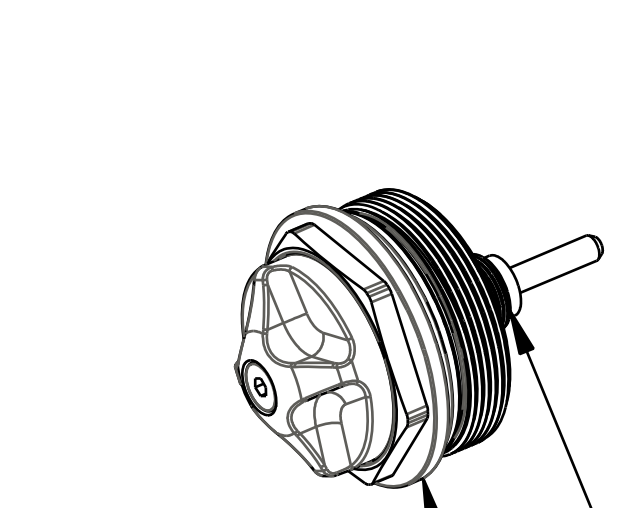

- 820-03-193
Sealhead Assy, 10mm Shaft, Dual Stepseal, 15mm Bushing, D-Wiper
- 820-05-041-KIT
Topcap Assy, 2011 32 80-150 TerraLogic

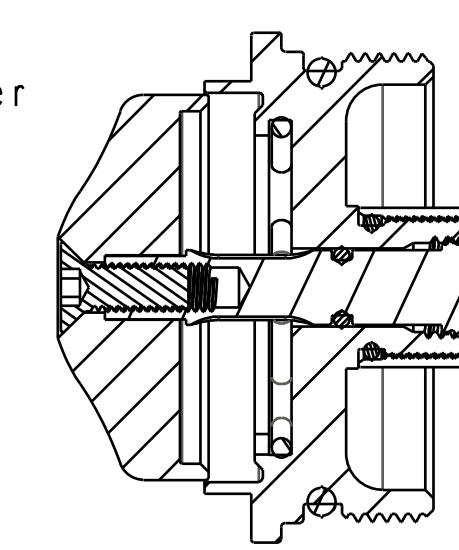

210-03-121
Shaft, 10mm, Machined, 2011 32 TerraLogic

OIL:
COAT BORE
WITH ATF

GREASE:
THIN LAYER OF
SLICK HONEY

LOCTITE:
ONE DROP OF
RED 262

TORQUE:
25±5 IN-LB

LOCTITE:
1 DROP OF RED 262
MIDWAY ON FEMALE THREAD

IMPORTANT:
VERIFY ORIENTATION
SMALL END TOWARDS
CHECK LIMITER

IMPORTANT:
VERIFY 100% THAT CHECK
SHIM IS NOT CLAMPED

IMPORTANT:
VERIFY ORIENTATION
SMALL HOLES TOWARDS
CLAMPED REBOUND SHIMS

TORQUE:
55±5 IN-LB

FOX Factory, Inc.
130 Hangar Way, Watsonville, CA 95076 USA
Ph 831-768-1100 Fax 831-768-9312

TITLE
**DAMPER ASSY, MY11 32
TERRALOGIC**

SIZE DWG. NO.
D

PLOT SCALE 1.00:1

SHEET 1 OF 1

THIS DOCUMENT CONTAINS PROPRIETARY INFORMATION THAT IS FOX PROPERTY. DO NOT DISCLOSE TO OR DUPLICATE FOR OTHERS EXCEPT AS AUTHORIZED BY FOX.